

DESIGN

VECTOR LINES & EMBEDDED B&W IMAGES

Suggested Software



Illustrator Rhino 8 not yet supported
Rhino 7
AutoCAD

LAB-ACCEPTED FILE FORMATS: .AI, .DWG, .3DM

YOUR ARTBOARD MUST MATCH **THE EXACT SIZE** OF YOUR MATERIAL



MAX SIZE 48" X 27"

OUR MATERIAL TEMPLATES!!

POSSIBLE TECHNIQUES

CUTTING
DTL

ETCHING
DTL

RASTERING
DTL

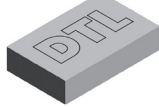

RGB: 255, 0, 0
0.01 pt stroke
no fill

RGB: 0, 0, 255
0.01 pt stroke
no fill

RGB: 0, 0, 0
no stroke
black fill

If you need a larger cutting area, **submit a project request** on our website!

Using grey tones will change the strength of the raster! fun!

VERY VERY VERY IMPORTANT!

Make sure to embed images and expand the appearance of custom fonts, brushes, and strokes.

LASER CUTTING

MATERIALS

LASER CUTTERS CAN ONLY CUT FLAT MATERIALS

MATERIALS WE CAN SUPPLY

CARDBOARD
PLYWOOD baltic birch
MDF
ACRYLIC in clear, frosted, white, black & mirrored

1/16", 1/8" & 1/4" (material dependent)

! WE **CANNOT** CUT !

FIRE HAZARD
polycarbonate, double-walled cardboard & warped materials
WILL NOT CUT
metals, glass, stone & tile
TOXIC FUMES
ABS, foam core, synthetic leather, vinyl, PVC & styrene

WE CAN CUT BUT DO NOT SUPPLY

COTTON
ORGANZA
SATIN
SILK
DENIM
CANVAS
FELT

ACETATE
DICHOIC FILM
PAPER
CARD STOCK
MYLAR
REAL LEATHER
ORGANIC LEATHER

LINOLEUM
SOFTOLEUM
THIN SPONGES
HANDMADE PAPER
MELAMINE
TYPES OF WOODS
PET-G

MOST COMMON MATERIAL THICKNESS IS 1/8"

BRINGING IN YOUR OWN MATERIAL

All outside sourced material must be staff-approved prior to use. This can be done as you drop off the material or during Open LAB hours. Make sure to bring extra material for testing!

PRICING

JOB COST IS CALCULATED ACCORDING TO:

TIME

\$0.42 PER MINUTE

this includes the use of the laser as well as any project consulting, material setup & more

FOOD FOR THOUGHT

files that are more detailed, have lots of rastering or are on thicker material will take longer and will cost more!

MATERIAL

THE COST VARIES BY KIND, THICKNESS, SIZE, AND AMOUNT using your own material has no material charge

FULL LIST OF MATERIALS WITH PRICING IS AVAILABLE ON OUR WEBSITE!

SUBMISSION & PICKUP

SERVICE BUREAU SUBMISSIONS ARE COLLECTED VIA GOOGLE FORM. FIND THE LINK ON OUR WEBSITE OR SCAN THIS QR CODE



SUBMIT YOUR FILE AT LEAST 1 WEEK IN ADVANCE TO ENSURE YOUR JOB IS PROCESSED IN TIME

ONCE YOU SUBMIT

Your file gets added to the Service Bureau queue which staff tackle on a first-come, first-served basis.

NO RUSH JOBS
NO QUEUE HOPPING

AFTER SUBMITTING

Keep an eye on your email as staff may reach out with questions, concerns, or any issues.

MINOR ISSUES: can be troubleshooted by LAB staff
MAJOR ISSUES: may result in your submission being cancelled

THE LAB ONLY ACCEPTS ONECARD AS PAYMENT

we recommend loading your One-Card beforehand which can be done in-person @ the OneCard office, @ the campus PHIL machines, or online. Link with this QR code:



WE WILL EMAIL YOU WHEN YOUR PIECE(S) ARE READY WITH YOUR TOTAL You will have two weeks to pick up your piece(s)-get in touch if that doesn't work for you!